

Northwest Map and Directions

Address: 1040 NW 22nd Ave., Ste 320 Portland, OR 97210

From the South

- Travel North on I-5
- At the 1-5 split, stay left toward City Center
- Follow signs to I-405/City Center/Beaverton exit (exit 299B)
- Take Exit 2B, Everett Street, onto 14th Street
- Continue on 14th Street. Turn left onto NW Marshall Street

From the West

- Travel East on US26/Sunset Highway
- Exit onto I-405 – Seattle/St Helens
- Take exit 2B, Everett Street, onto 14th Street
- Continue on 14th Street. Turn left onto NW Marshall Street
- Turn left into Parking Structure 2 between 21st and 22nd Ave

From the East

- Travel West on I-84
- Follow signs to I-5 North (right lanes)
- Follow I-5 North to Exit 302B
- Take exit 302B across the Fremont Bridge, stay to the right
- Take Vaughn Street Exit (Exit 3)
- Turn left onto NW 23rd Ave (first light after Vaughn St exit)
- Turn left onto NW Northrup Street
- Turn right onto NW 22nd Ave
- Turn left onto NW Marshall
- Turn right into Parking Structure 2

From the North

- Travel South on I-5
- Take exit 302B across the Fremont Bridge
- Cross the Willamette River on Fremont Bridge, stay to the right
- Take Vaughn Street Exit (Exit 3)
- Turn left onto NW 23rd Ave (first light after Vaughn St exit)
- Turn left onto NW Northrup Street
- Turn right onto NW 22nd Ave
- Turn left onto NW Marshall
- Turn right into Parking Structure 2

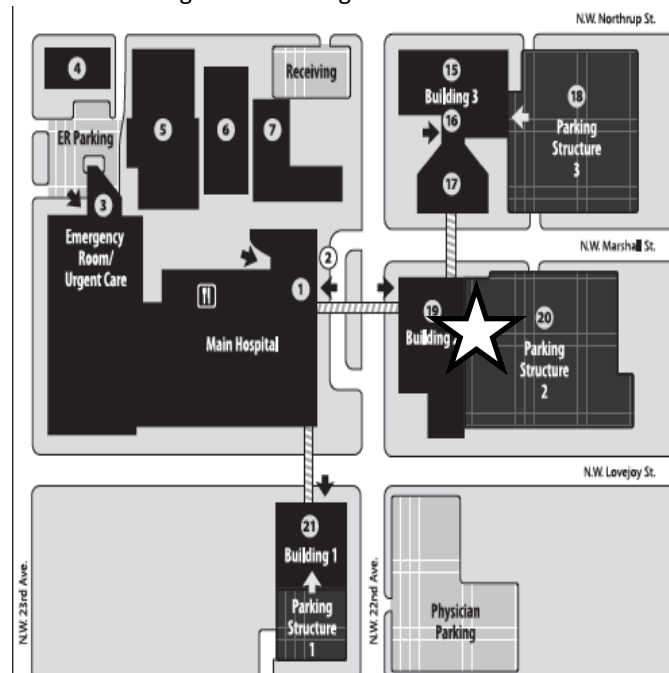

Parking at the Good Samaritan Campus

We have several options for parking:

Use our parking structure. You may park for free in any of the three parking structures, which have gates. Please take a ticket upon entering and, at the conclusion of your appointment, RMA will issue you a parking validation ticket free of charge. If you enter the parking structure and exit within 15 minutes, no validation is required.

Valet parking. You may use Legacy's free valet parking from 7 a.m. to 5 p.m. at the main hospital entrance, N.W. 22nd Avenue and Marshall Street.

Street parking. Street parking may be available. Please observe all posted placards.

Handicapped parking. The easiest accessible handicap parking to RMA is on level H of parking structure 2.

Tualatin Map and Directions

From the South

- Travel North on I-5
- Take exit 289, turn right at the light
- Follow the curve to the right, proceed on SW 65th Ave
- Turn left into the entrance to Legacy Meridian Park Medical Center
- Make the second left and park in any designated patient space
- Inside the building, take the elevator to the second floor to reach Suite 250

From the West

- Travel to I-5
- Follow remaining directions from the South or North (according to your proximity to the Nyberg St exit)

From the East

- Travel West on I-205
- Take exit 3, turn right onto Stafford Road
- Turn left onto Borland Road and proceed to SW 65th Avenue (approximately 4 miles)
- Turn right onto SW 65th Ave
- Make the first right into Legacy Meridian Park Medical Center
- Make the second right and park in any designated patient space
- Inside the building, take the elevator to the second floor to reach Suite 250

From the North

- Travel South on I-5
- Take exit 289, turn left at the light
- Cross the overpass and proceed on Nyberg Road
- Follow the curve to the right, proceed on SW 65th Ave
- Turn left into the entrance to Legacy Meridian Park Medical Center
- Make the second left and park in any designated patient space
- Inside the building, take the elevator to the second floor to reach Suite 250

